



**SANTA ANA COLLEGE
FACILITIES COMMITTEE MEETING
AUGUST 21, 2018**



**SANTA ANA
COLLEGE**



PROJECTS

- ▶ Dunlap Hall Renovation - Completed
- ▶ Central Plant & Infrastructure - Completed
- ▶ Johnson Student Center & Demolition
- ▶ Science Center & Building J Demolition



PROJECT UPDATE SANTA ANA COLLEGE SCIENCE CENTER & BUILDING J DEMOLITION

Project Summary:

- ▶ Construction of a new three-story, 64,785 square foot science center and 880 square foot greenhouse
- ▶ Programs Include: Division Office, Faculty Offices, (2) Standard Classrooms, (1) Large Classroom, (1) Large Divisible Classroom, (1) Computer Lab, (1) Engineering Lab & Support Space, (6) Biology Labs & Support Space, (2) Geology Labs & Support Space, (5) Chemistry Labs & Support Space, (1) Physics Lab & Support Space, Student Collaboration Areas
- ▶ Project includes demolition of (3) J Buildings

Current Status:

- ▶ New Shallow Under Slab Utilities
- ▶ New Exporting of Dirt Spoils
- ▶ New Exterior Underground Plumbing
- ▶ New Completed Importing of Under Slab Select Fill Material
- ▶ New Completed Forming and Pouring of Pile Caps and Grade Beams
- ▶ New Completed Underground Site Utilities
- ▶ New Completed Underground Chilled Water Lines
- ▶ Target occupancy Summer 2020

Budget: \$73.38 million





PROJECT UPDATE SANTA ANA COLLEGE JOHNSON STUDENT CENTER

Project Summary:

- ▶ Demolition of existing building.
- ▶ Construction of a 63,642 square foot new Johnson Student Center
- ▶ Building Programs Include: Campus Store, Grab-n-Go/Coffee & Juice, DSPS, EOPS/CARE & CalWORKS, Student Financial Services, SSSP/Upward Bound, Warehouse, Reprographics, Conference Center, Financial Aid, Student Placement, Health & Wellness Center, DSPS, Office of Student Life, ASG, The Spot
- ▶ Site improvements include new hardscape, landscape and shade shelter around the Johnson Center as well as renovations to the "West Plaza" including new landscape, hardscape, a shade structure, and a lunch serving kiosk for Middle College High School (MCHS)



Current Status:

- ▶ Increment 1 (Site Preparation) received DSA approval on February 20, 2018
- ▶ Increment 2 (Building) was submitted to DSA on February 15, 2018 and approval anticipated August 2018
- ▶ New RFP for lease-leaseback construction delivery is anticipated to be solicited in September 2018
- ▶ New Bid phase anticipated September – November 2018
- ▶ Target construction start Winter 2018 - Spring 2021
- ▶ Target occupancy Spring 2021

Budget:

- ▶ \$51 million (Budget is under review pending bid phase)
- ▶ \$44.27 million funded by Measure Q
- ▶ Note: The budget is currently deficient by \$6.73 million and a new budget update is pending upon a reallocation of budgets from the Central Plant project



SCHEDULED MAINTENANCE PROJECTS SANTA ANA COLLEGE

PROJECT	STATUS	ESTIMATED BUDGET
Water Conservation (SM 15-16)	A Notice of Completion was approved by the Board of Trustees on August 13, 2018. This project will be removed from future updates.	\$96,915 (under review)
Window Replacement (H) (SM 16-17)	The windows have been installed and new concrete has been installed at the main entrance. Temporary relocation of summer office workstations to Russell Hall R-118B was completed. The building punch walk was completed. The District has rejected the window installation due to failure to pass water test. The scope of corrective work is currently under review and a timeline for correction has yet to be determined.	\$731,535* * Budget Breakdown: <ul style="list-style-type: none"> • \$440,000 funded by SM17 • \$260,000 funded by the Campus • \$31,535 funded by Capital Facilities Fund
Future Barrier Removal (SM 18-19)	A new state allocation is anticipated for 18-19. The District is currently evaluating a restroom upgrade as a potential barrier removal project.	\$431,479





CURRENT CAPITAL PROJECTS

RUSSELL HALL REPLACEMENT (HEALTH SCIENCES BUILDING)

Project Summary:

- ▶ Construction of a new 55,138 square foot Health Sciences Building to include Nursing, Occupational Therapy Technology, Emergency Medical Services, Pharmacy Technology, general classrooms and computer labs. The new building will be located south of the existing library and north of the new Science Center
- ▶ Demolition of existing Russell Hall Building
- ▶ The District will have to adhere to a strict state process and guidelines

Current Status:

- ▶ New The Preliminary Plan was approved by the State on June 6, 2018
- ▶ New The design team is working on 60% construction drawing plans that is due to the District in September 2018
- ▶ New The geotech/geohazard report will be submitted to California Geological Survey for review/comment
- ▶ **No changes are allowed to square footage and/or programs**
- ▶ DSA submittal anticipated February 2019
- ▶ DSA approval anticipated November 2019
- ▶ Target construction start April 2020
- ▶ Target occupancy May 2022

Budget:

- ▶ **\$58.8 million*** (District to contribute 50% - subject to change based on annual State Budget changes for inflation adjustments)
- ▶ \$20,475,000 state funded
- ▶ Budget under review



RUSSELL HALL REPLACEMENT SECONDARY EFFECTS PROJECTS SANTA ANA COLLEGE

PROJECT	STATUS	ESTIMATED BUDGET
Campus Entrance Improvements	This project is in the initial start-up of planning. An RFP for architectural services has been solicited on August 13, 2018 with a due date of September 14, 2018.	\$3.38 million

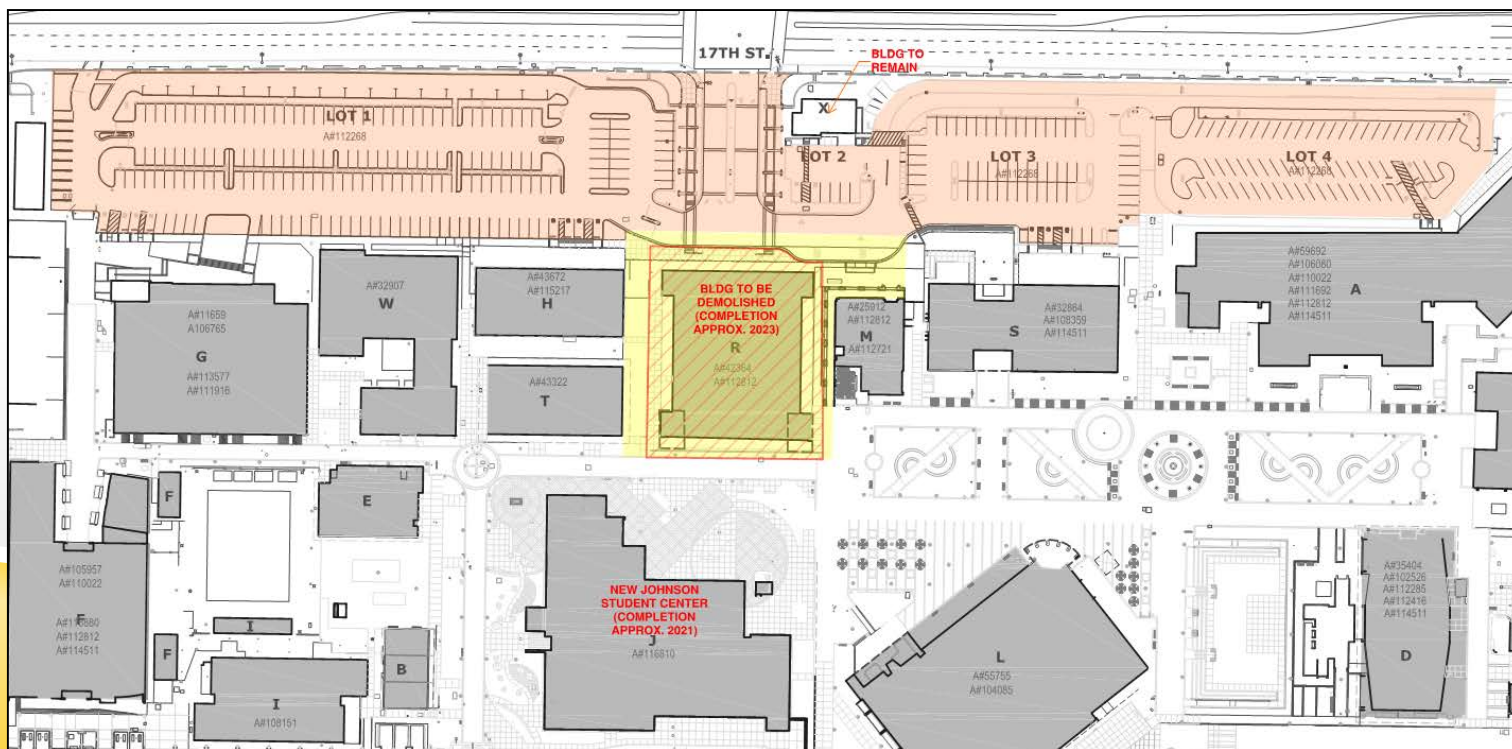

CURRENT CAPITAL PROJECTS

SANTA ANA COLLEGE

PROJECT	STATUS	ESTIMATED BUDGET
Campus Directory & Wayfinding	The architect presented the design on July 26, 2018 to the District and college. The architect walked with campus staff and the locations for the directories were confirmed by the campus. Electrical requirements were confirmed on with the architect and the electrical engineer. The scope of work includes making modifications to the existing wayfinding monument signs by adding direction. In addition, new ones and various signs will be added to enhance the exterior wayfinding around the campus and parking lots.	\$82,500 (under review)



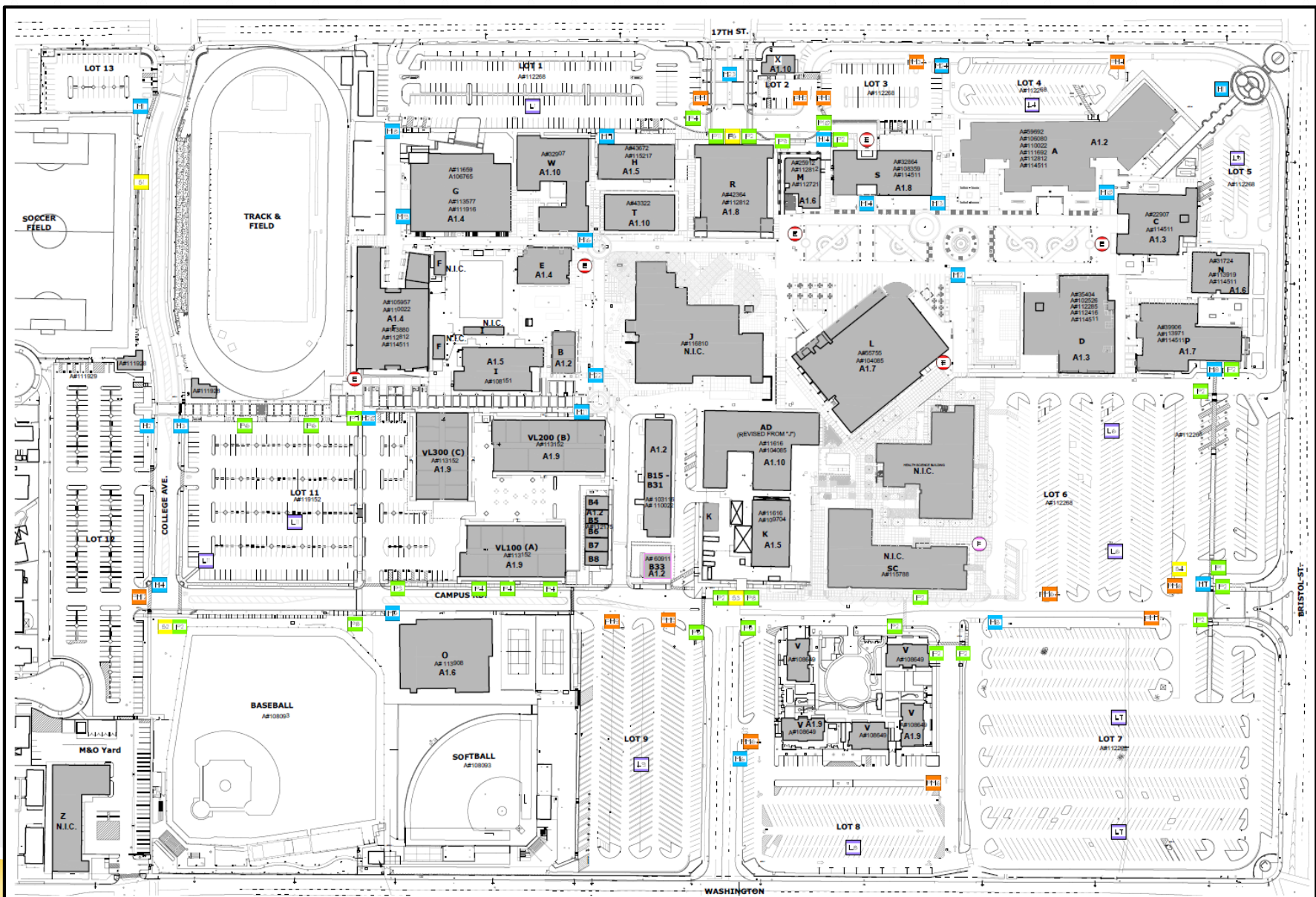

1 SITE PLAN SCALE: 1" = 80'-0"



KEYNOTES

1. REMOVE EXISTING STOP SIGN REF-R CONCRETE PAVING (WHERE OCCURS)
2. REMOVE EXISTING U-TURN SIGN
3. REMOVE EXISTING FREE-STANDING DIRECTORY RETURN TO DISTRICT AND REF-R CONCRETE PAVING
4. REMOVE EXISTING NO DROP-OFF OR PICK-UP SIGN

LEGEND

LOT SIGN REF-R	FUTURE SITE DIRECTORY SIGN
HORIZONTAL SIGN REF-R	ELECTRONIC DIRECTORY REF-R
HORIZONTAL SIGN REF-R	FUTURE DIRECTORY SIGN
LOT SIGN REF-R	

CAMPUS DIRECTORY & WAYFINDING SANTA ANA COLLEGE

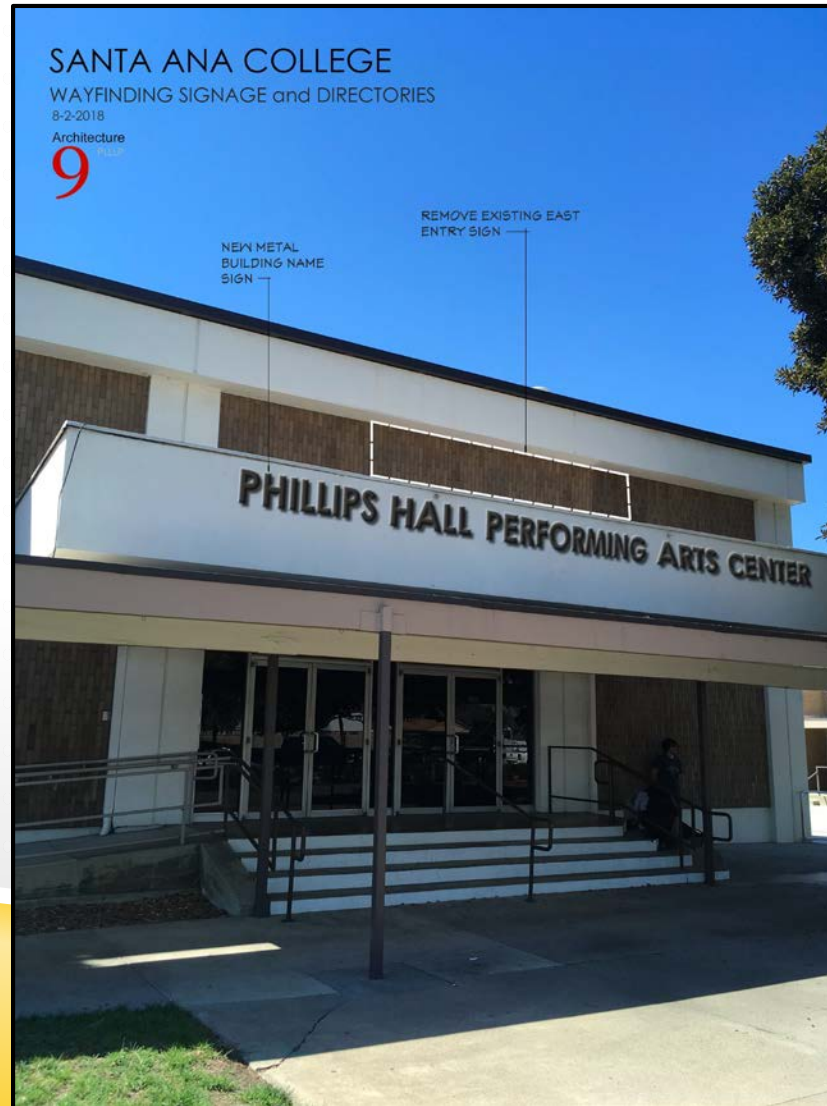

CAMPUS DIRECTORY & WAYFINDING SANTA ANA COLLEGE



CAMPUS DIRECTORY & WAYFINDING SANTA ANA COLLEGE



CAMPUS DIRECTORY & WAYFINDING SANTA ANA COLLEGE





CURRENT CAPITAL PROJECTS SANTA ANA COLLEGE

PROJECT	STATUS	ESTIMATED BUDGET
Barrier Removal Signage/Wayfinding	This project is for miscellaneous additional accessibility signage as needed (i.e. signage in Parking Lot 11 to fields).	\$115,000
Barrier Removal Exterior (Parking Lot 9 Stalls)	This project bid was rejected as the bids came in over budget. Therefore, the construction fencing will now remain in place. The construction fencing and logistics staging plan is under review for both Science Center and Johnson Student Center projects. No changes to fencing in this lot at this time.	\$275,000 (under review)
Chavez Hall Renovation	New carpet and vinyl flooring has been replaced in the A-107 front offices in the Business Development Department. The College Maintenance group touched up paint in this location at the request of the faculty. Furniture was returned to this space after painting was completed on July 13, 2018. The next phase of work will be in the Fire Tech Offices which is tentatively scheduled for winter break.	\$388,851 (under review)
Facility Modification Requests (FMRs) – AR 6601	The campus has currently submitted 20 FMRs and are in various stages of the review and approval process.	N/A



YEAR FIVE PROP 39 PROJECTS

SANTA ANA COLLEGE, SANTIAGO CANYON COLLEGE, DIGITAL MEDIA CENTER, ORANGE COUNTY SHERIFF'S REGIONAL TRAINING ACADEMY, DISTRICT OPERATIONS CENTER

Project Summary:

- ▶ LED lighting conversion at Santa Ana College, Santiago Canyon College, Digital Media Center, Orange County Sheriff's Regional Training Academy and District Operations Center

Current Status:

- ▶ Building G and W interior work is complete
- ▶ Building Z exterior canopies are complete
- ▶ Building 930 exterior is complete
- ▶ Upcoming activities include exterior installation at Buildings C, I and L and exterior installation of canopies in Buildings D and H

Budget:

- ▶ \$993,328



CURRENT PROJECTS DISTRICT-WIDE

PROJECT	STATUS	ESTIMATED BUDGET
District-Wide Emergency Blue Phone & ADA Path of Travel (SAC, SCC, CEC, DO, OCSRTA, DMC)	The project is now anticipated to go out to bid in September with a contract award anticipated for Board consideration in November or December. The District is still in the process of procuring blue phones as an owner furnished item, contractor installed coordinated project and working with the Purchasing Department on procurement of the phones. The project duration for construction is anticipated to be six - eight months.	\$1.9 Million



CURRENT PROJECTS DISTRICT-WIDE

PROJECT	STATUS	ESTIMATED BUDGET
District-Wide Access Control & Door Hardware Survey Assessments	<p>A. A meeting was conducted with the colleges on July 9, 2018. Three firms demonstrated access control software products to the Working Group (representatives from SAC, SCC, ITS and Safety & Security) on July 12, 2018. A follow up access control software demonstration is scheduled for September 17, 2018. Software products are still under review with a recommendation forthcoming by the Working Group.</p> <p>B. The district-wide door survey started on July 30, 2018 based on the draft schedule. It is anticipated to finish on or around the week of August 13, 2018.</p>	\$62,800
AR 6520 Safety of District Property – Keying Guidelines	C. The District is working with a consultant and with both campus Working Groups to retain feedback on the development of keying, re-keying, and access control guidelines to ensure consistent integrity is maintained for both key and access control systems per AR 6520.	N/A
Future Retrofit & Access Control Project	D. AR 6520 will be updated once the guidelines are completely developed. A new plan will be developed as part of this planning process as the last step is to identify future projects, building door retrofits (i.e. hardware changes, for locks, access control, etc.).	TBD



ADA TRANSITION PLANNING UPDATE AND SELF EVALUATION

The Working Group has been meeting and working on developing a first draft of the Self Evaluation and Transition Plan update. The next Working Group meeting is scheduled for September 19, 2018.



QUESTIONS

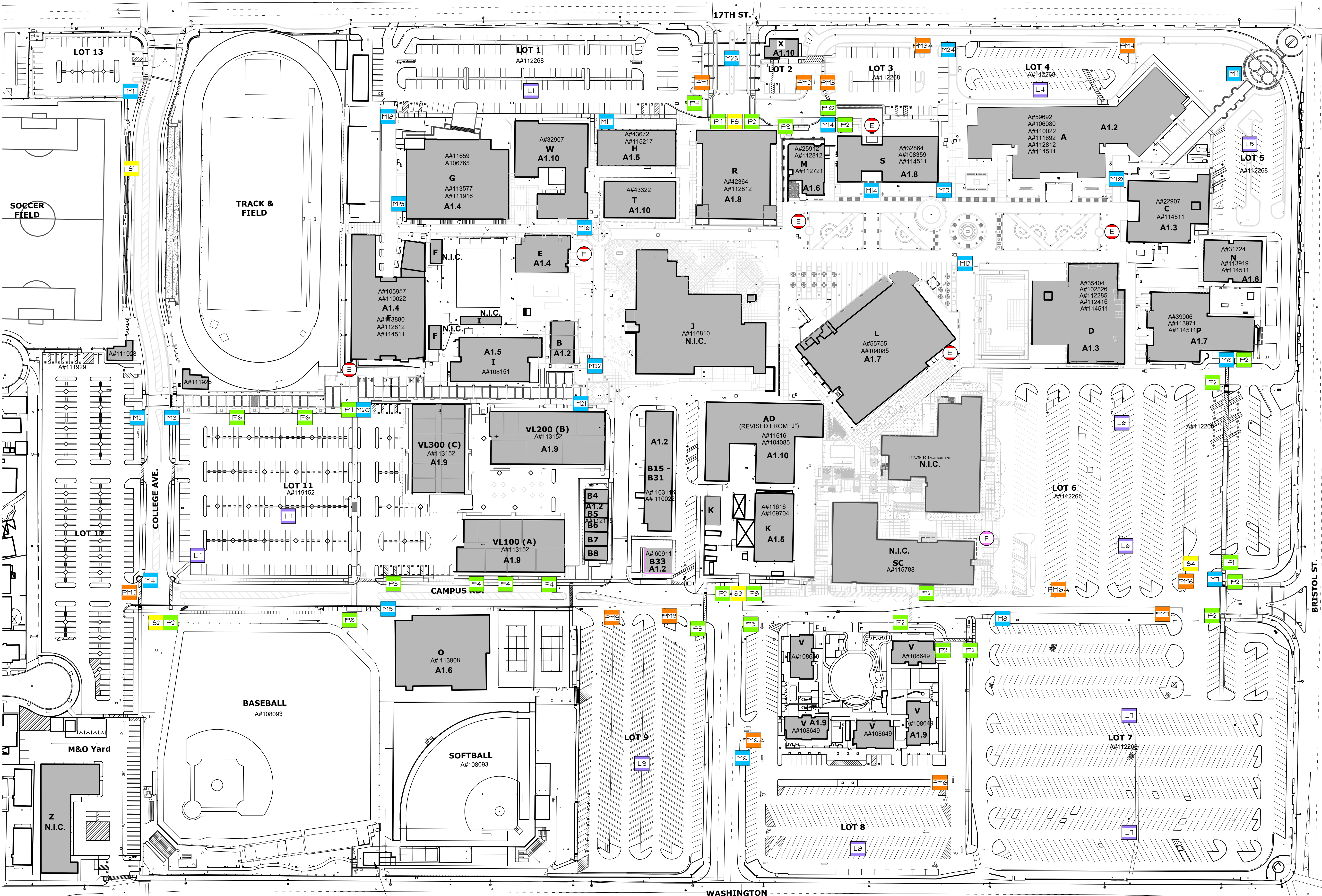

1 SITE PLAN
SCALE: 1" = 80'-0"



KEYNOTES

1. REMOVE EXISTING STOP SIGN, REPAIR CONCRETE PAVING (WHERE OCCURS)
2. REMOVE EXISTING U-TURN SIGN
3. REMOVE EXISTING FREE-STANDING DIRECTORY, RETURN TO DISTRICT AND REPAIR CONCRETE PAVING
4. REMOVE EXISTING NO DROP-OFF OR PICK-UP SIGN

LEGEND

	POST SIGN, RE:3/A4.1		SITE DIRECTIONAL SIGN, RE:4/A4.1
	MONUMENT SIGN, RE:A2 SERIES		FUTURE SITE DIRECTORY SIGN
	PARKING LOT MONUMENT SIGN, RE: A3 SERIES		ELECTRONIC DIRECTORY, RE:6/A4.1
	LIGHT POLE SIGN, RE:5/A4.1		FUTURE DIRECTORY (N.I.C.)

ARCHITECTS STAMP:

NOT FOR
CONSTRUCTION

CONSULTANT:

CONSULTANTS STAMP:

AUTHORITY APPROVAL:

IDENTIFICATION STAMP
DIV. OF THE STATE ARCHITECT

APPL

AC _____ FLS _____ SS _____
DATE: _____

SCHOOL DISTRICT:

RANCHO
SANTIAGO
COMMUNITY
COLLEGE
DISTRICT

PROJECT:

SANTA ANA
COLLEGE
WAY FINDING
SIGNAGE &
DIRECTORIES

JOB NUMBER: 80.03.00

DATE: 07/26/18

REVISION:

DATE: _____

REVISION:

DATE: _____

DRAWING TITLE:

SITE PLAN

DRAWING NO.:

A1.1